

12.12.94

SECTOR-4

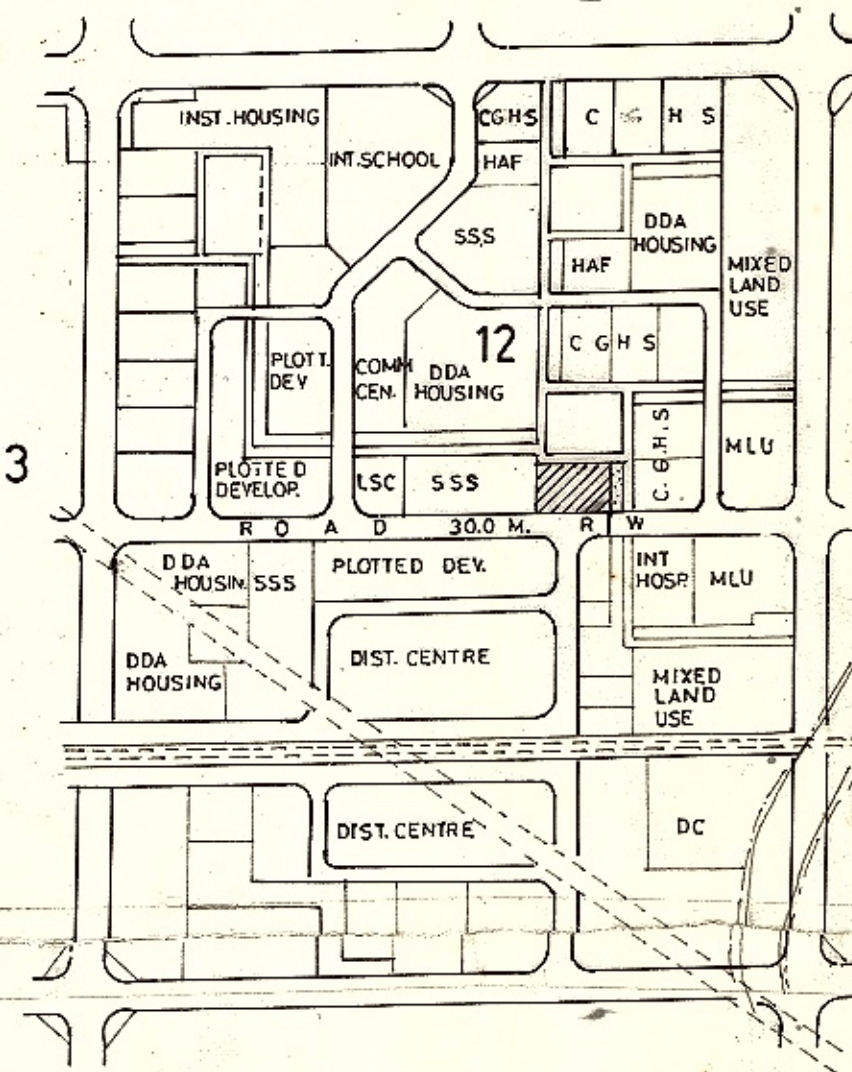

SECTOR 13

SECTOR 11

SECTOR 18

KEY PLAN

AREA STATEMENT

TOTAL AREA OF THE SITE 7150.00 Sq.m.

Sl. no.	FACILITY	PROPOSED AREA IN SQ.M.	GRD. COV.	F.A.R	MAX. HT.
1	PRIMARY SCHOOL MIDDLE SCHOOL	3997.50 4000.00	33.00	100	14
2	C.S.C	1170.00	33.33%	66.66	8 m
3	DISPENSARY	1012.50	33.33%	100	14 m
4	COMMUNITY ROOM	570.00	33.33%	75	14 m
5	RELIGIOUS	400.00	33.33%	66.66	8 m

OTHER NORMS - AS PER MPD 2001

NOTES

- DO NOT SCALE THE DRAWING FOLLOW ONLY THE WRITTEN DIMENSIONS.
- ALL THE DIMENSIONS SHALL BE CHECK BEFORE EXECUTION.
- INTERSECTION TO BE DESIGN LATER.

NOTE:-

PKT. NO Pkt 'a' APPROVED BY DIR (Plg) ON Pg. 6N IN FILE NO - F 8 (10) 94/DWK/HAF B/Part.

APPROVED BY V.C., D.D.A. DT 9/9/96 AT PAGE 8/NIN
FILE NO - F 8 (10) 94/DWK/HAF B/PART I

i) THE PLAN IS SUBJECT TO MODIFICATIONS WITHIN THE FRAMEWORK OF MASTER PLAN/ZONAL PLAN.
ii) IT IS FOR PLANNING PURPOSE & IS NOT FIT TO BE PRODUCED IN THE COURT OF LAW FOR PROPERTY DISPUTES.
iii) ALL THE DIMENSIONS & AREA GIVEN IN THE PLAN ARE SUBJECT TO CONFIRMATION OF OWNERSHIP/ALLOTMENT STATUS AND DEMARCATIIONS/FEASIBILITY REPORT FROM THE DDA LANDS & ENGINEERING WING RESPECTIVELY.

HOUSING AREA FACILITY Pkt. 'a'

10 5 0 10 20 1:500 SCALE

SECTOR 12 (PH I)

PLG. D/MAN	S. P. KAUR PLG. ASSTT.	DRG. NO. 12(A)-HAF/94/04	DATE
T. SINGH ASSTT. DIRECTOR	ANIL BARAI JOINT DIRECTOR	S. SRIVASTAVA DIRECTOR (PLG)	

DELHI DEVELOPMENT AUTHORITY

IDWARKA SUB-CITY (PAPANKALAD)

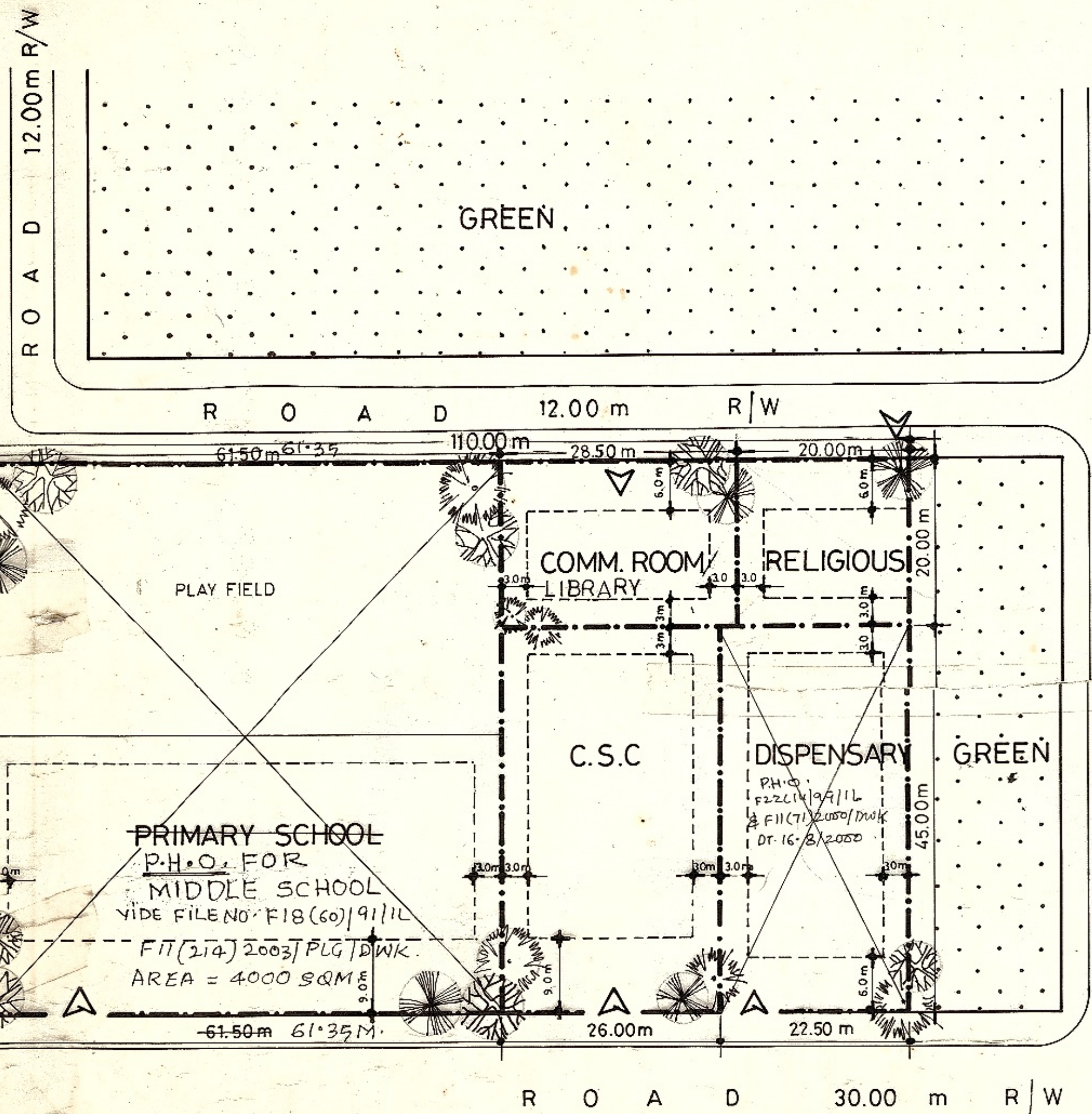

CGHS

SSS